

Oceanic

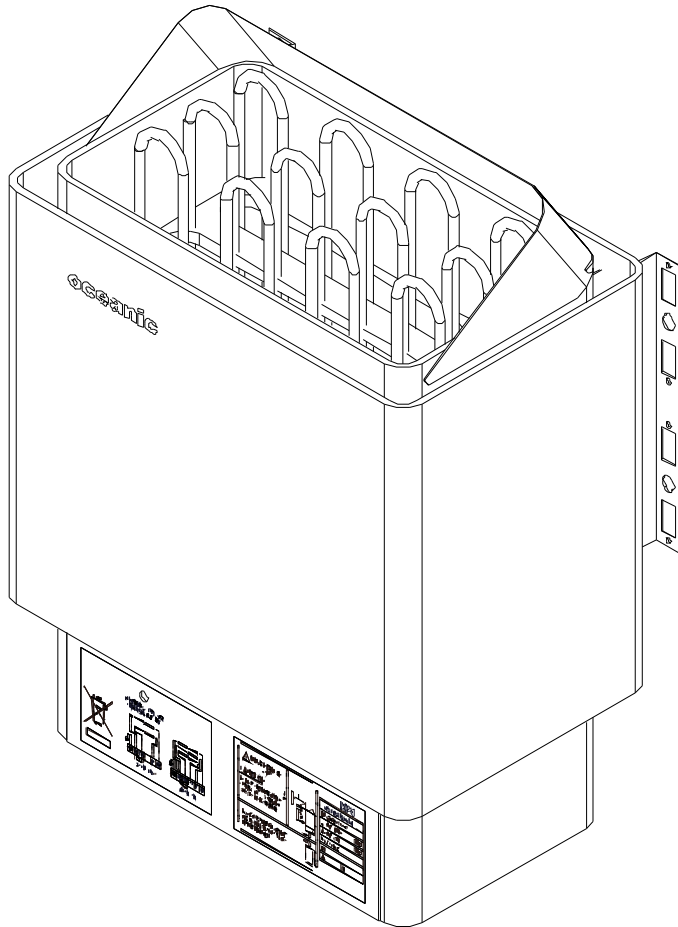

USER MANUAL

MODEL:

- OCS30
- OCS40
- OCS45
- OCS60
- OCS80
- OCS90

Welcome to select the above OCS Heater
Read the user manual before using the heater

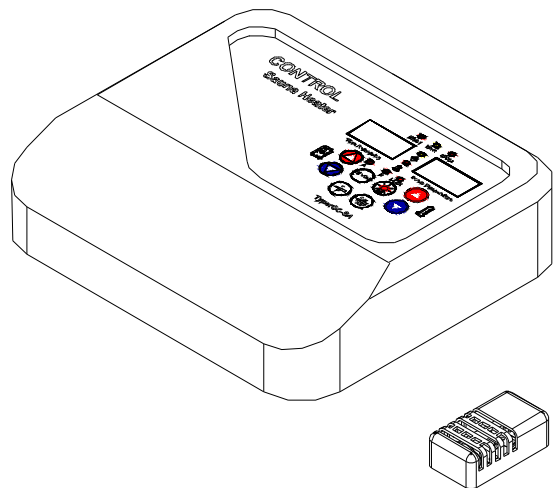

The Heater

- Installation
- Operation

Foreword

Thank you for choosing to buy our Oceanic Sauna heater, please take the time to read these instructions before you begin as they contain important information about the installation and maintenance requirements.

“Oceanic” sauna heater are available in specifications from 3kw to 9kw and are equipped with our OC-SA digital controller. With this not only can you control the temperature and time duration of your sauna bath but also the light of the sauna room, alter the temperature display between Centigrade and Fahrenheit; as well as displaying the sauna heater’s 8 status by the 8 LEDs on the controller, heating, light, temperature ,waiting, working model status etc.

Every “Oceanic” sauna heater is thoroughly tested before leaving the factory.

Important:

- △ read the manual before installation and operation; keep it for user
- △ This equipment must be installed by competent person;
- △ Disconnect the power supply before exposing electrical connections;
- △ Confirm the right voltage to your steam generator 1 or 3 phase
- △ The sauna heater is forbidden to used for other purpose ;
- △ Never cover anything on heater lest cause fire;
- △ Don’t operate sauna heater without sauna stone;
- △ Don’t touch the working heater as it is very hot;
- △ Sauna heater must has right earth connection. and the earth wire should be bigger then the power supply wire to sauna heater

SAFETY PRECAUTIONS FOR SAUNA:

- △ Elderly persons, pregnant women, or these suffering heart disease, high blood pressure, diabetes or not in good health are advised to seek medical opinion before using a sauna room;
- △ Do not smoke in the sauna room;
- △ Avoid using the sauna room immediately after strenuous exercise;
- △ Do not use the sauna room when under the influence of alcohol;
- △ Leave the sauna room at once if you feel sleepy, sick or uncomfortable;
- △ Ensure there is good ventilation for the sauna room
- △ We do not recommend this product is used by children under 16 years old;
- △ Commercial operators should post a notice of these precautions in a prominent position

Chapter one : Specification

1. Parameter and size of sauna heater (chart 1)

Chart 1

Model	power	input		size(mm)			Heat element quantity	Sauna stone (Kg)
	(Kw)	1N~	3N~	L	W	H		
OCS30	3.0	230V		410	280	570	2	12-14
OCS40	4.0	230V		410	280	570	2	13-15
OCS45	4.5	230V	400	410	280	570	3	14-16
OCS60	6.0	230V	400	410	280	570	3	16-18
OCS80	8.0	230V	400	410	280	570	3	18-20
OCS90	9.0	230V	400	410	280	570	3	18-20

2. Parameter and size of OC-SA controller (chart 2)

Chart 2

Model	Input		Output		Load power (Kw)	Size(mm)		
	1N~	3N~	1N~	3N~		L	W	H
OC-SA I	230V		230V		3~4	248	217	78
OC-SA II	230V	400V	230V	400V	4.5~9	280	217	78

3. Parameter and size of temperature sensor (chart 3)

Chart 3

Model	Detected scope		Cut off on high temperature		Size (mm)		
	°C	°F	°C	°F	L	W	H
OC-S	0~110	32~230	120	248	76	42	27

4. circuit Diagram for sauna heater and controller

i. sauna heater circuit diagram(fig 1)

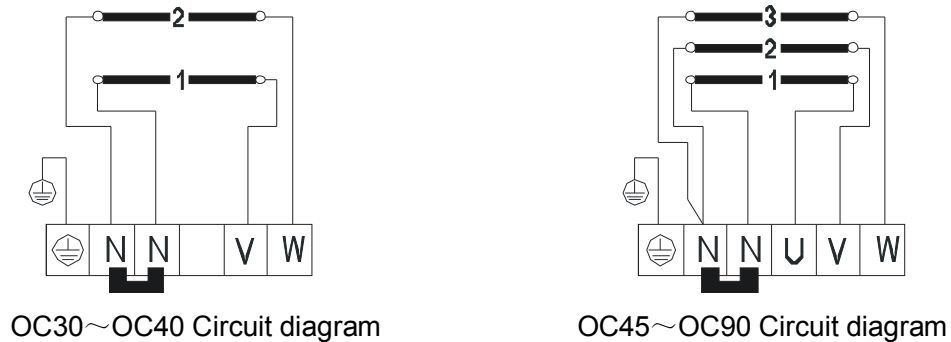

(Fig1)

ii. circuit Diagram for controller (fig2, Fig3)

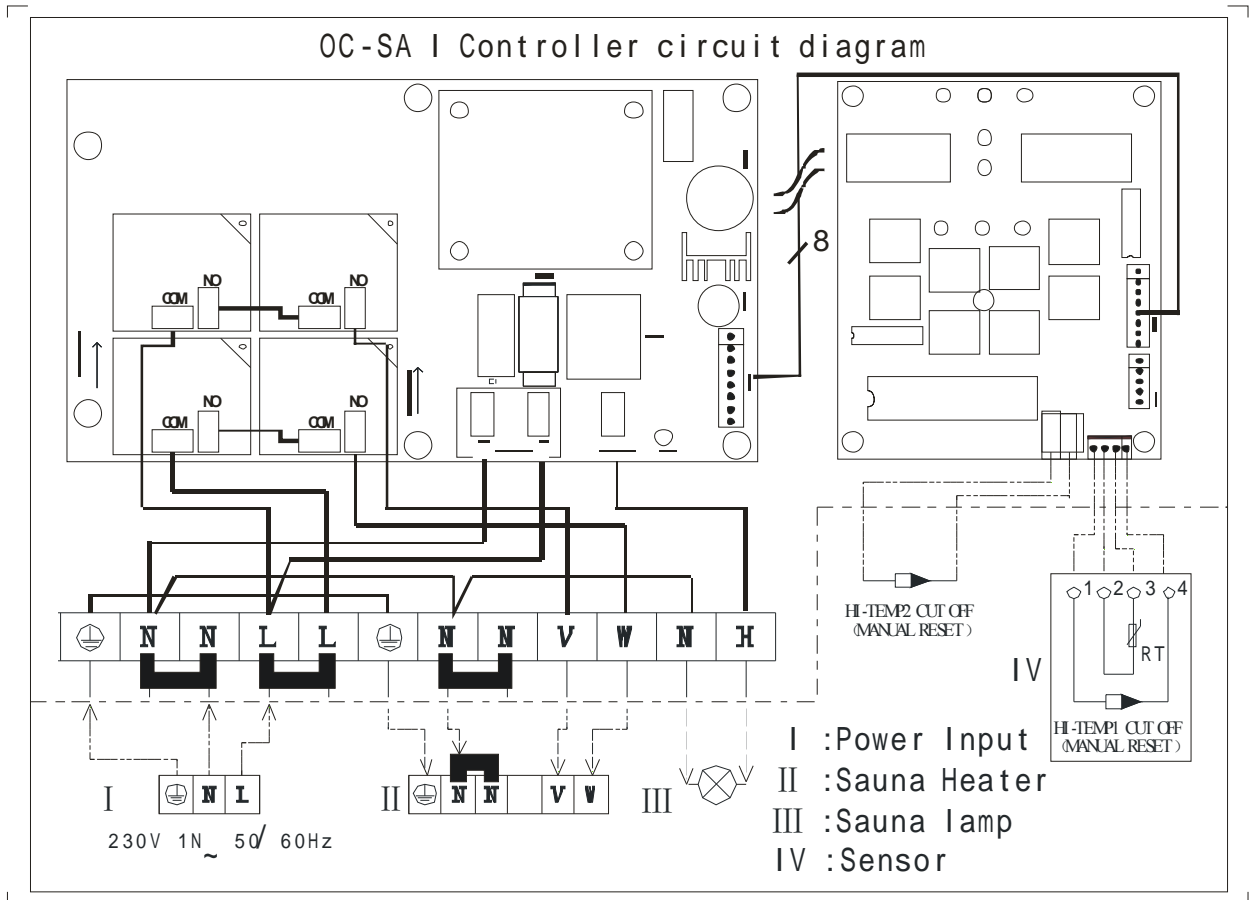

(fig 2)

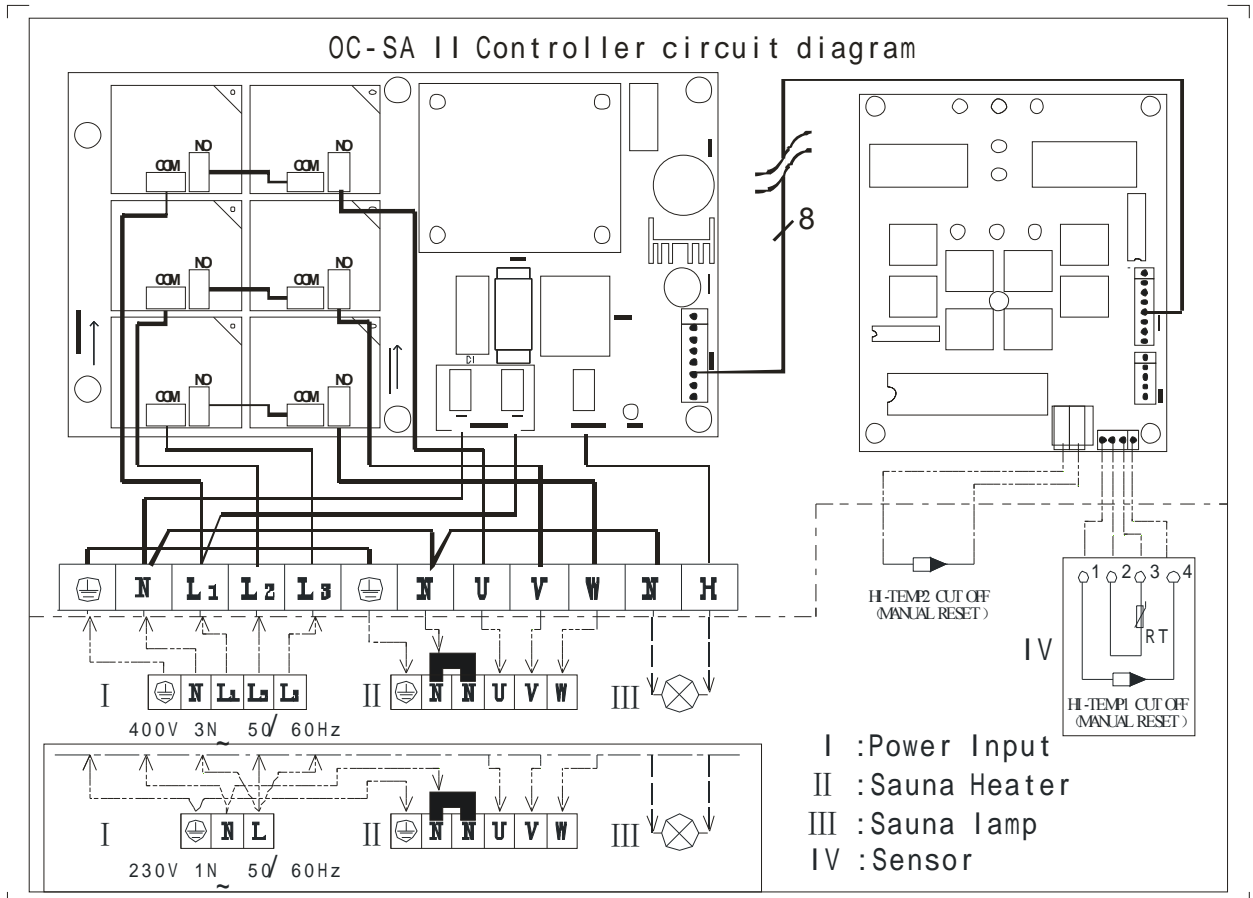

(Fig3)

Chapter Two: frame and functions

1. Sauna heater frame and parts

(1) sauna heater frame(fig 4)

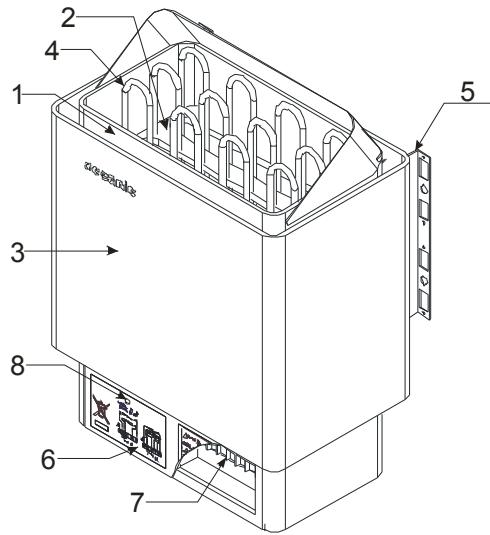

(fig4)

(2) parts (chart 4)

Chart 4

No.	parts	description
1	Inner shell	Hold heat element and sauna stone
2	Stone bracket	support the sauna stone
3	Shell	Insulate the inner shell to prevent from scalding
4	Heat element	heating
5	Fix bracket	Fix sauna heater on wall
6	Cover Panel	Cover the electrical parts and
7	terminal	Connect the power supply
8	High temperature cut off sensor	Prevent from the temperature being too high underneath of sauna heater

2. Controller frame and parts

(1) controller frame (fig 5)

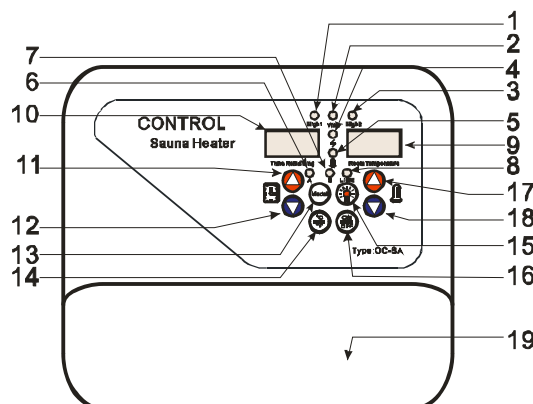

(2) keys and LED instruction(chart 5)

Chart 5

No.	parts	description
1	High1 LED	Indicator LED for over heat in sauna room ,it is on means need reset by hand the sauna heater will rework
2	Wait LED	Indicator LED for waiting work status, it is on means on B work model
3	High2 LED	Indicator LED for over heat in stove , it is on means need reset by hand the sauna heater will rework
4	Heating LED	Indicator LED for heating ,it is on means sauna heater is heating
5	Heat preservation LED	Indicator LED for Heat preservation ,it is sauna heater is on Heat preservation status
6	A model LED	Indicator LED for A model. it is on means sauna heater is working on A model
7	B model LED	Indicator LED B model, means sauna heater is on waiting status
8	Light LED	Indicator LED for lamp in sauna room
9	Temp display windows	Display the detected temperature of sauna room
10	Time display window	Display the rest work time or waiting time
11	Time Increase button	Increase button
12	Time decrease button	Decrease button
13	Model switch button	Switch the work model between A and B model
14	°C/F button	Switch the temperature display between centigrade and Fahrenheit
15	Light	Push to operate for light in sauna room
16	ON/OFF	Push to operate
17	Temp Increase button	Increase button
18	Temp decrease button	Decrease button
19	Controller shell	Hold controller parts

3. Temp sensor frame and parts

(1) Temp sensor frame (Fig 6)

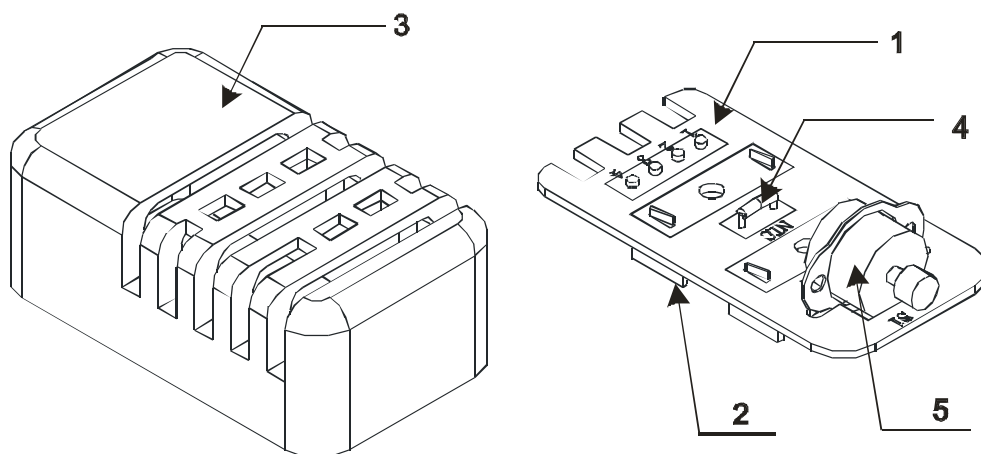

(Fig6)

(2) Temp sensor instruction (chart 6)

Chart 6

No.	parts	Description
1	Circuit board	Circuit board
2	bracket	bracket
3	cover	Protect t the electronic
4	Heat resistance	Detect temperature
5	High Temp cut of switch	When temperature in sauna room exceed 120°C or 248 °F

Chapter Three: installation

1. Important

- △ confirm the model you have selected is suitable for your sauna room, please refer to chart 7;
- △ ensure the power supply voltage match the sauna heater request;
- △ Isolate the power supply before installation
- △ the installation position must comply to the minimum distance as chart 4 lists, also must consider the safety and convenience (chart 8)
- △ the minimum height of you sauna room must be 1900mm, please refer fig 7C;
- △ don't install sauna heater on floor or in cabinet;
- △ you can't cover the sauna heater back with asbestos ,cement or similar material;
- △ the wire enter sauna room should refer chart 7, and the wire must can endure 170 centigrade temperature (high temperature rubber wire is recommended) ;
- △ Don't install two or more sauna heater in one sauna room. unless install the same power sauna heater ,and the distance between sauna heaters must exceed 400mmm ;
- △ It is very hot when the sauna heater working .in order not to burn user, there should be a enclosure for sauna heater, the enclosure can be made in different type ,but some size must comply fig 7D ,the size parameter can refer chart 8 and chart 7;
- △ The upside screws must be fixed tightly, there is 3mm gap between the screw head and wall(refer fig 4A ,fig4B)
- △ If you need connection box in sauna room ,the box must be water-proof and there is \varnothing 7MM hole for moisture condensation, the box center shouldn't 500MM higher than floor;
- △ Controller should be installed on outside dry wall
- △ The installation height of controller should between 1200MM-1500MM .so that easy to control and operate;

△ Temperature should be installed in sauna room ,but not above of sauna heater ,and the height should be 1500-1800mm from floor. The level distance to sauna heater should exceed 500mm

Chart 7

model	Sauna room		Min distance from sauna heater to (mm)				wire (mm ²)		current (A)		Fuse (A)	
	Volume (M ³)		Distance to shelf over 500mm above the floor	Ceiling	floor	230V 1N~	400V 3N~	230V 1N~	400V 3N~	230V 1N~	400V 3N~	
	Min	Max										Min height (mm)
OCS30	2	4	1900	50	1100	180	3×1.5		13		20	
OCS40	3	5	1900	50	1100	180	3×2.5		17		25	
OCS45	4	6	1900	80	1100	180	3×4	5×1.5	19.5	6.5	25	10
OCS60	5	8	1900	150	1100	180	3×4	5×1.5	27	9	40	16
OCS80	7	11	1900	200	1100	180	3×6	5×2.5	35	12	60	20
OCS90	8	12	1900	200	1100	180	3×6	5×2.5	39	13	60	20

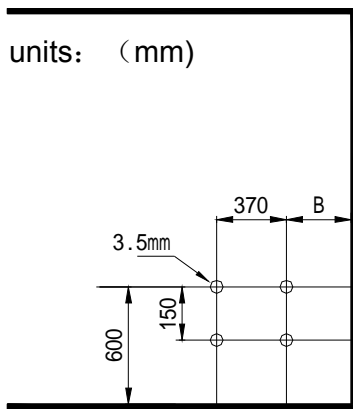

Fig 7A

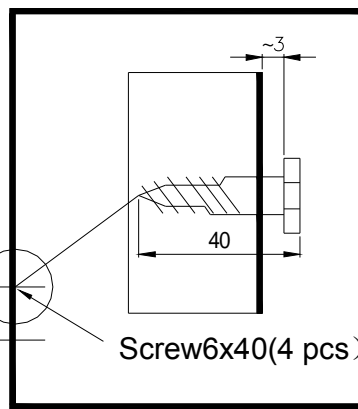

fig 7B

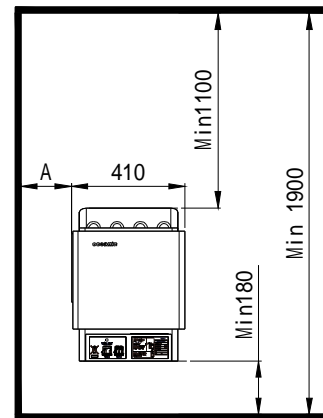

fig 7C

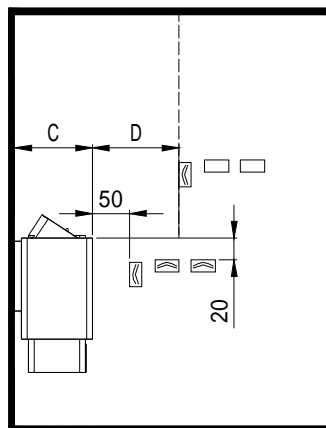

Fig 7D

Model	Min distance (mm)			
	A	B	C	D
OCS30	50	70	280	100
OCS40	50	70	280	100
OCS45	80	100	280	100
OCS60	100	120	280	150
OCS80	130	150	290	200
OCS90	130	150	290	200

chart 8

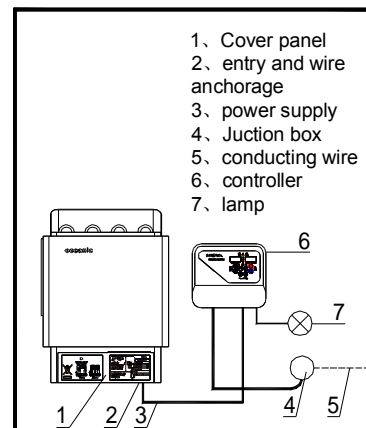

fig 8

2. Installation for sauna heater

- (1) refer the installation drawing fig 7A, 7B ,Fix screws and hang sauna heater on wall
- (2) remove the cover panel. connect power supply wire ,control cable from the knock-out hole to Terminal as fig 8;
- (3) cover the panel and fatten the screws;

3. Installation for controller .

- (1) Controller should be installed on outside dry wall
- (2) fix a screw on 1200MM-1500MM height place on the wall, remain 3mm gap between the screw head and Wall ;
- (3) remove the screw on the side bottom of controller ,open the cover and knock out the wire control entry;
- (4) located the hole of controller on to the screws , then fix two screws pass the two holes on to wall and fasten them
- (5) according the connection drawing of controller connect the wire on to terminal ,ensure it is tight
- (6) cover the cover and fasten them.

4. Installation for Temp sensor (fig 9)

- (1) install the temperature sensor on the height between 1500-1800MM in sauna room;
- (2) open the cover with a screwdriver;
- (3) fix the bottom of the temperature sensor on to wall with screw;
- (4) cover the cover;

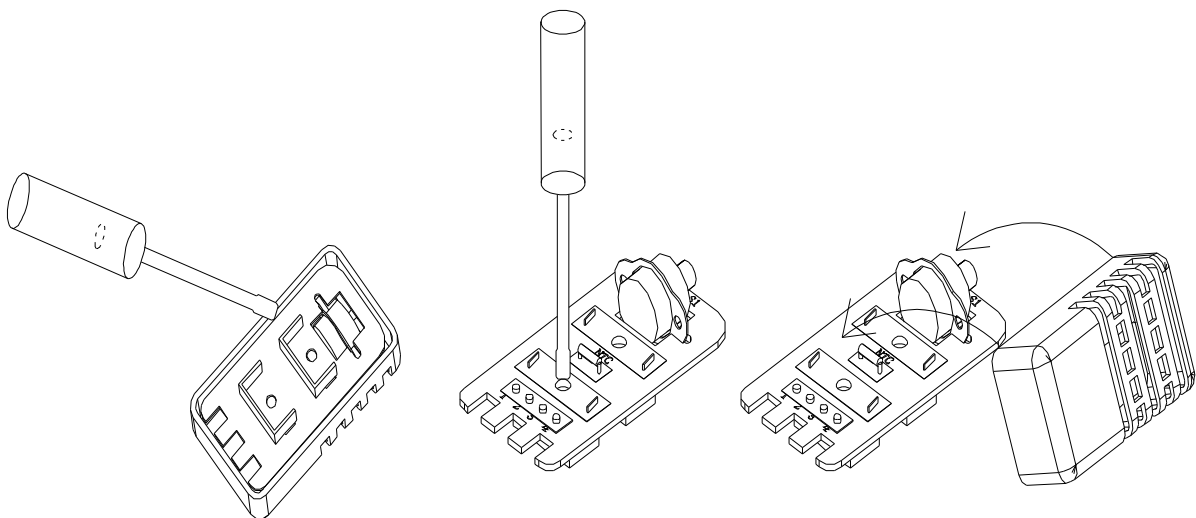

(fig 9)

5. Sauna heater .controller and temperature sensor connection drawing (fig10A,fig 10B,fig 10C)

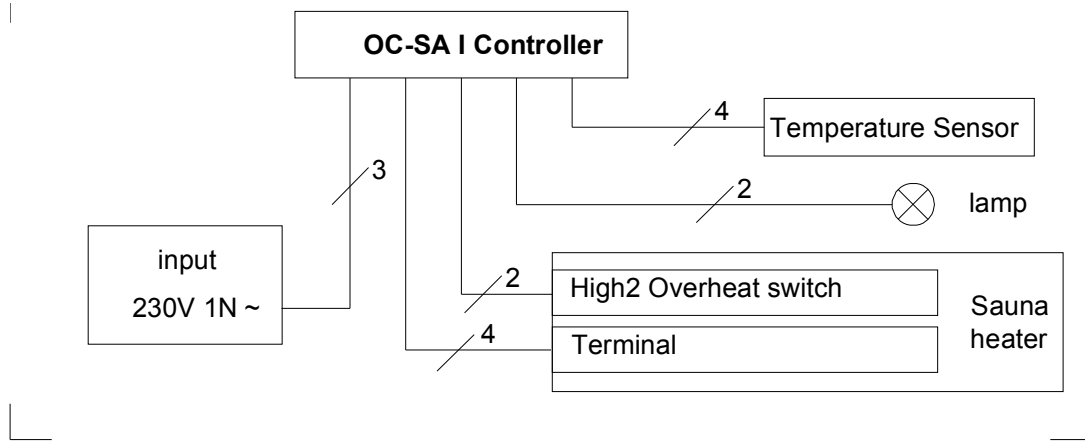

(Fig 10A)

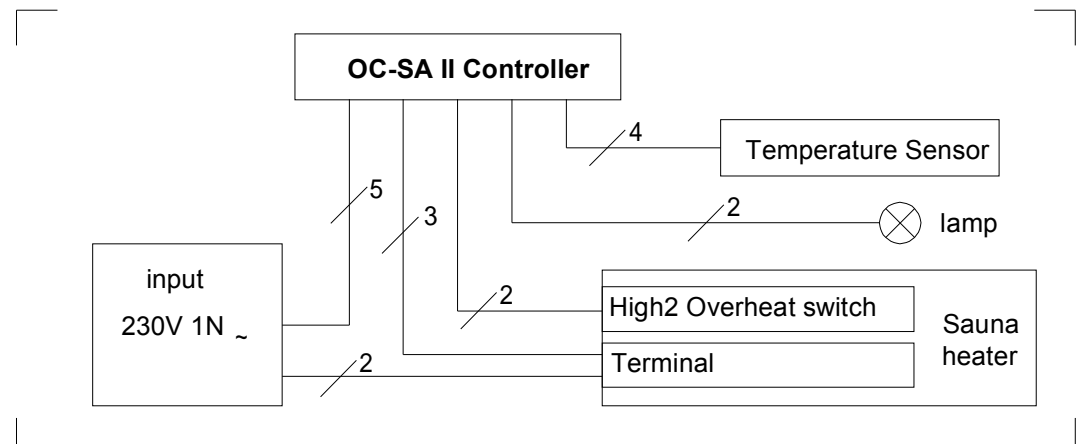

(Fig 10B)

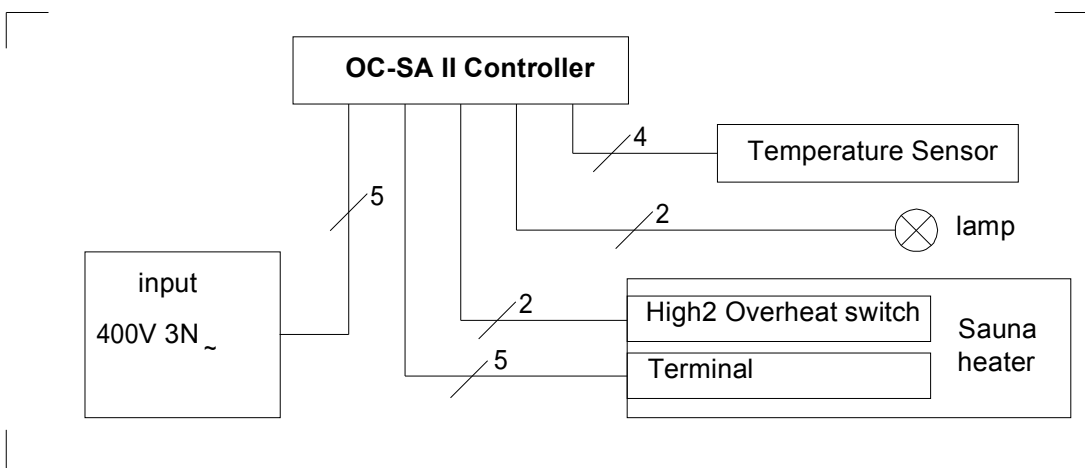

(Fig 10C)

Chapter Four: Testing and operation

1. Testing

- (1) after check the sauna heater installation is right ,load sauna stone, notice put the big stone on the bottom ,small stone on top, and the stone can't be too dense so that the air can circulate, also if the stone

can't be too tight otherwise it will break the heat elements, make sure the stone will cover the heat element ,change sauna stone after certain time (fig 11)

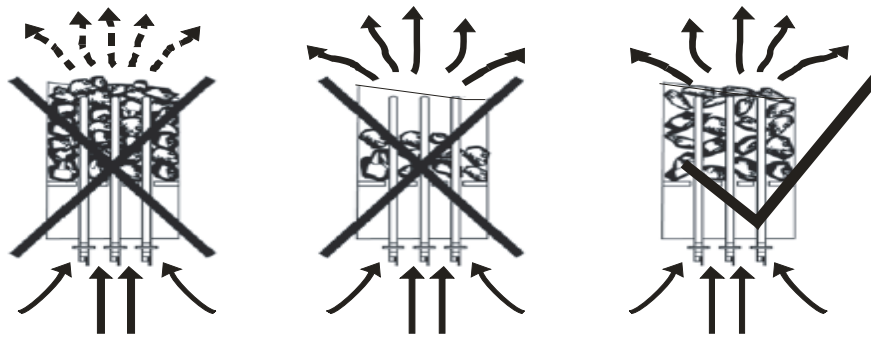

(fig 11)

- (2) before connect to power supply ,check the sauna heater first (make sure there is no other things around sauna heater) . Notice at first, when the sauna heater works , the heater and stone may emit some smell, make sure the sauna room is ventilated .
- (3) connect to power supply ,press “ON/OFF “, temp and time widows will display data, LED shows the status, sauna heater start heating , the temperature of sauna room will rise and will achieve the preset temperature (the default temperature leave factory is 70 °C/158°F , work time is 2 hours) chart 9
- (4) the time is count down, when time window display “0”, sauna heater will stop working , controller will turn off automatically ,no any display on controller , need the sauna heater rework ,press “ On/off ” and preset again ;
- (5) when the temperature setting finished ,sauna heater has sequential heating function. when switch on all heat elements will work together until the sauna room temperature achieve the target temperature , two bank heat elements will stop work (for OCS30,OCS40 ,one bank will stop), when sauna room temperature is 2°C/ 4 °F above the target temperature ,all heat elements will stop work . the sauna room temperature will debase and when sauna room below the target temperature, one bank heat element will work again ,when the temperature is 2°C/ 4 °F below the target temperature, all heat elements will work again. Such as ,we preset the temperature is 70°C/158°F): when the detected temperature achieve70°C/158°F) ,two bank elements will stop work (for OCS30,OCS40 ,one bank will stop),when the temperature is higher than 72°C/163°F , all heat elements will stop work ,when the detected temperature is below 70°C/158°F , one bank heat elements will work again. when the temperature low than 68°C/154°F ,all heat element will work again.
- (6) light button: control the light in sauna room ;;
- (7) use temperature switch button to change the temperature display between centigrade and Fahrenheit
- (8) working model button: A model: working directly, the time window display the rest time. Every time when

you turn on sauna heater ,the default is A model.

B model: sauna heater will work after the preset time, the time window display the rest waiting time, when the time window display 0 ,it will change to A model and the sauna heater will stat heating at once, and the work time is the preset time under A model. when the rest working time finished ,the windows will be 0 ,sauna heater will stop work. for example: under A model ,setting the work time is 3 hour, change to B model, and setting the waiting time is 5 hours .then after 5 hours , sauna heater will enter A model automatically . after 3 hour-work ,sauna heater will stop work.

chart 9

Model	Default model	Default Temp		Temperature adjust scope		
		°C	°F	°C	°F	
OC-SA I OC-SA II	A	75	167	50~110	122~230	
	A	75	167	50~110	122~230	
	Default time			Time adjust scope		
	Working time	Waiting		Work time	Waiting time	
	2 hours	4 hours		30 minutes~8 hours Or Long (no time limited)	0~12 hours	
	The time adjustment difference for every press			The temperature adjustment difference for every press		
	10minutes			1°C/2°F		

2. Setting time and temperature:

- (1) when sauna heater leave the factory .the default setting are 75 °C/167 °F) and 2 hours of operation, these can be adjusted by customer, remind once the controller lack of power supply .it will return to default .
- (2) time setting, every turn on, sauna heater will work under A model(A model LED is on),the time window will display the last setting time ,press the time adjust button “ ▲ ” or “ ▼ ”,every press the time will increase or reduce 10 minutes .when reach the time you requests, after 5 seconds, time windows will stop flash ,the setting is confirmed. If need sauna heater to work after a certain time.first setting the working time under A model. Then press the model button change to B model (B model LED is on). And the time windows will display 4:00, press the time adjust button “ ▲ ” or “ ▼ ”,every press the temperature will increase or reduce 10 minutes. when reach the time you requests, stop pressing after 5 seconds, time windows will stop flash ,waiting time under B model setting is confirmed. Then the waiting time will counts down. when the time windows reach 0, it will

change to A model and start work as the setting working time under A model.

For the time setting , you can also press “ ▲ ” or “ ▼ ”for 3 seconds , after 3 second ,the time will increase or reduce automatically ,when it reach to the time you need , release the press, it will confirmed after 5 seconds.

(3) temperature: by pressing temperature display switch button ,choose centigrade or

Fahrenheit ,press temperature adjustment button “ ▲ ” or“ ▼ ” one time ,the temperature windows will flash, then press the time adjust button “ ▲ ” or “ ▼ ”,every press the temperature will increase or reduce 1 °C or 2 °F . when reach the temperature you requests, stop after 5 seconds, temperature windows will stop flash ,temperature setting confirmed is confirmed.

For the temperature setting , you can also press “ ▲ ” or “ ▼ ”for 3 seconds , after 3 second ,the temperature will increase or reduce automatically ,when it reach to the temperature you need , release the press, it will confirmed after 5 seconds.

Chapter Five: Toubleshoot Guide

Please Note that we recommend all repairs are carried out by a suitably qualified

Trouble description	Cause	Solutions
Turn on power supply, press ON/OFF,no display on control panel	There is something wrong with 1.power supply 2.circuit board transformer 3.fuse	1. Check the power supply. If the power supply indicator LED L1 (red),IF THE I1 is on ,check the wire 2. change the controller
The controller is on,sauna heater don't work	1. The sauna heater hasn't been connected . 2. something wrong with controller	1、 check the connection, refer to fig 2and fig 10 2、 change controller
High1 LED is on	1. the temperature sensor hasn't bee connected well 2.the high temperature cut off switch is turned off	1、 check the connection to temperature sensor 2、 check if the high temperature cut off switch is turned off, if yes ,reset by hand
High2 LED is on	The temperature in the stove is too high	1. change sauna heater 2. reset the high temperature cut off switch by hand

Wait LED is on	Sauna heater is under B model	If need heat at once ,change to A model
Temperature windows display --L°C(or °F)or --H°C(or °F)	<ol style="list-style-type: none"> 1. temperature hasn't connect well or the cable breaks 2. the temperature lower than 0°C (or 32°F) 3. the temperature detected higher than 115°C (or 239°F) 	<ol style="list-style-type: none"> 1、 --L°C(or °F) means temperature sensor hasn't connected or the temperature lower than 0°C (or 32°F) ,check the connection ,cable or change sensor 2、 --H °C(or °F) means it is short circuit for the temperature sensor or the temperature higher than 115°C (or 239°F) ; check the connection ,cable or change sensor 3、 Change controller

Chapter Six: Warranty and maintenance

The warranty is limited .from the day you bought in one years or the sauna heater left factory in 18 month. we will repair or change the electrical parts which caused by low quality material or production except the accessories, for the heat elements ,the warranty time is from the day you installed in 90 days or left factory in half year. we can decide to repair or change the parts.

- 1) the conditions which we make notes are not included .
- 2) as the problems caused by wrong installation, operate or connect the wrong power supply or repaired by the person whom we think is not competent are not included in the warranty
- 3) if exceed warranty term ,we still supply maintenance service. but this will be charge
- 4) for after sale service ,please contact local dealer.

Thank you!